

Express

July 2023
ISSN:2463-560X

Rural Women
NEW ZEALAND
Ngā Wāhine Taiwhenua o Aotearoa

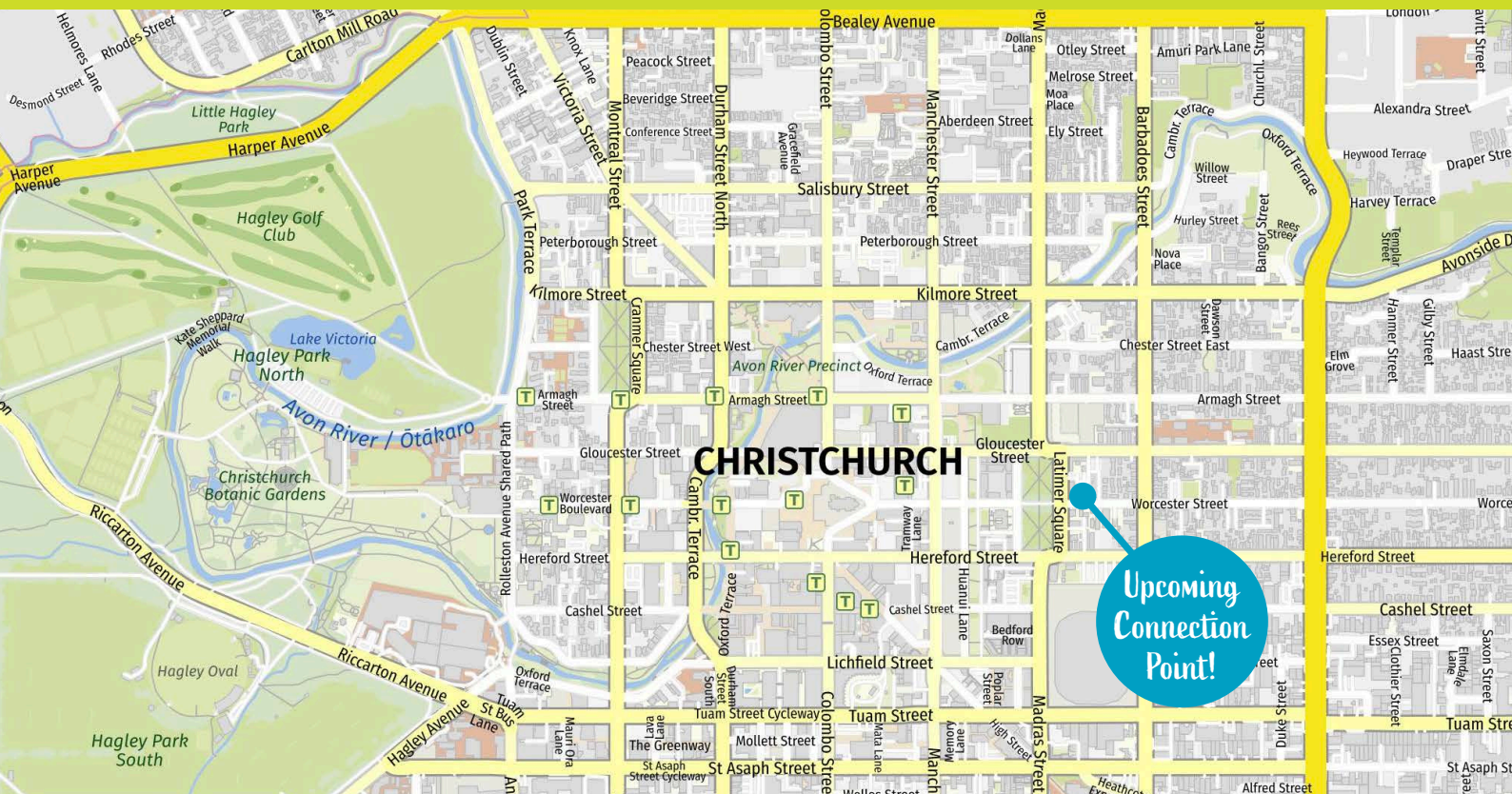

National Conference

23-25 November 2023 - Christchurch

If there is one theme that runs through almost every aspect of Rural Women New Zealand, it is how vital connection is in everything we do.

Reaching out to others is important for all of us but especially so for those in rural Aotearoa New Zealand. You will see the thread of connection running through this edition of the Express.

It has been vital in the response to the horrendous damage done by weather events. It is essential for wellbeing, both personally and within a community. It ties together like-minded women gathering from all over to focus on issues that affect us all.

Connection also transcends time and place. It was one of the primary reasons that this organisation was started nearly a century ago. It is as relevant today as members network and connect to support rural people and communities.

Our ability to connect has morphed in recent times as technology presents new options and as we adapt to increasingly busy lives. But if you look on the faces of the people in the pictures in this issue, you will see that there is nothing like coming together in person.

In November, we can meet together at the National Conference. Come to Christchurch, learn something new, meet new people, celebrate and connect.

The most important things in life are the connections you make with others. - Tom Ford



ACWW Triennial World Conference

Kuala Lumpur, Malaysia 18 - 24 May 2023

Participants were welcomed at the Kuala Lumpur Airport on 17 May by representatives from the hostess Society, Pehang W.I. Following the welcome and introductory sessions, Area meetings were held on the first day ahead of the official opening, which was on day two.

The official opening ceremony on day two was a very ceremonial event including special guests their Royal Highnesses the King and Queen of Malaysia, and numerous other invited officials. The Queen's connection with the Pehang W.I. and ACWW at a global level added to the status of the Conference and attendees.

RWNZ's resolutions on rural and gender impact analysis and Women's Employment Action Plans were the only two policy resolutions that were passed virtually unanimously and without comment from the floor. I offer my sincere thanks to everyone who was involved in crafting the resolutions. I was proud, and humbled, to stand and present our resolutions at this global forum, and in my mind, those who contributed were there with me on that stage while doing so.

ACWW has refreshed its future strategy and the rationale behind this was explained. At a global level, connections with UNESCO, CEDAW, HLPF, and the UN continue to develop well with the focus shifting to issues that fit well with these international platforms.

ACWW have had to change how they manage their bank accounts to comply with UK charity regulations. This is

causing considerable concern in Australia as all transactions for the benefit of ACWW will now have foreign exchange fees applied and will remove the ability to complete transactions locally.

There is also concern at the change in how projects are managed with a small number of projects chosen around the world with potential to grow into larger projects instead of lots of smaller, localised projects. For the South Pacific, this would mean that supporting water tanks for the Pacific, for example, would no longer be an officially sanctioned project.

The announcement of the newly elected Board and Committee Chairs was made on the final day of the Conference. It was a very proud moment for our delegation as RWNZ member Claire Mahon was elected as the Chair of the Marketing and Communications Committee.

The closing ceremony was also a very formal, ceremonial affair but not to the extent of the opening as members of the royal family were not present. There was an interesting presentation from the city of Ottawa, the host for the next Triennial World Conference, which will be held at the end of April in 2026.

Each night there was a different culturally themed dinner and dance show, with music and dancing following the entertainment.

There was a day of field trips, where we were all taken by bus to our various destinations in fully police escorted motorcades, which was quite an experience!

Her Royal Highness, Queen Azizah of Malaysia, hosted us at the Royal Palace for an evening. Close to 500 conference delegates travelled to the Palace in seven double decker buses, with a full police escorted motorcade stopping all traffic and clearing our way. This was a once in a lifetime experience.

The hostess Society, Pehang W.I., was wonderful; so very generous, hospitable and gracious, yet lots of fun.

Area meetings at the close of Conference were officially cancelled as a small number of Covid cases were reported the night before. However, at a short informal South Pacific Area meeting, outgoing president Gail Commens was presented with a farewell gift from the Area. RWNZ also presented her with a silver brooch as a token of our appreciation for her work.

The 30th ACWW Triennial World Conference in Kuala Lumpur was an amazing experience. To meet with women from all over the world, the ACWW staff, the World President and Board and gain a much deeper understanding that ACWW's work was so very valuable. The experiences outside the formal Conference sessions were amazing and I am so very grateful to have represented Rural Women New Zealand.

Ngā mihi, *Gill*

NATIONAL BOARD OF RWNZ

National President

International Portfolio (Lead)

Education Portfolio (Joint Lead)

Gill Naylor, Alexandra

Phone: (03) 426 2731 Mobile: 027 338 3089

gill.naylor@ruralwomennz.nz

National Finance Chair

Annette Marr, Amberley

Mobile: 021 743 750

financechair@ruralwomennz.nz

National Chair and Board Member (North Island) / Health Portfolio (Lead)

Sandra Matthews, Tairāwhiti

Mobile: 027 496 6336

sandra.matthews@ruralwomennz.nz

Board Member (North Island)

Connectivity & Business Portfolio (Lead)

Claire Williamson, Cambridge

Mobile: 027 383 1299

claire.williamson@ruralwomennz.nz

Board Member (South Island)

Environment & Land-use Portfolio (Lead)

Education Portfolio (Joint Lead)

Emma Higgins, Nelson

Mobile: 027 600 5549

emma.higgins@ruralwomennz.nz

Board Member (South Island)

Community & Social Inclusion Portfolio (Lead)

Sharron Davie-Martin, Rangiora

Mobile: 027 475 4129

sharron.daviemartin@ruralwomennz.nz

NATIONAL OFFICE

Ph: 04 473 5524 or 0800 256 467

PO Box 12-021, Wellington 6144

Level 10/175 Victoria St, Wellington 6011

enquiries@ruralwomennz.nz

Chief Executive

Gabrielle O'Brien

ce@ruralwomennz.nz

Membership and Office Manager

Felicity Bunny

felicity.bunny@ruralwomennz.nz

Projects and Events Manager

Lisa Thompson

lisa.thompson@ruralwomennz.nz

Finance Co-ordinator

Janet Ziegler

accounts@ruralwomennz.nz

Communications and Social Media Support

Mia Cohen

mia.cohen@ruralwomennz.nz

Regional Connector

Kylie Bensemann

kylie.bensemann@ruralwomennz.nz

Dates for the Diary

Friday, 28 July: Entries close for the NZI Rural Women NZ Business Awards 2023

Wednesday, 2 August: Regional Leaders Hui, Wellington

Tuesday, 19 September: Suffrage Day

Saturday, 14 October: General Election Day

Sunday, 15 October: International Day of Rural Women

Thursday, 23 and Saturday, 24 November: RWNZ National Conference, Christchurch

Friday, 24 November: RWNZ Annual General Meeting, Christchurch

Friday, 24 November: NZI Rural Women NZ Business Awards 2023, Christchurch

Membership Renewal Update

By the time you're enjoying your Express magazine, our upgraded database system and Members area should be live. We have been working with a new provider - Gecco, a database software firm based in Waipukurau - to deliver a membership database experience which will take us into the future and develop alongside us as we continue to grow as an organisation. The new process should be much easier to navigate and will offer those who use it some great new features which we will be introducing over the next few months. As is usually the case with anything new, there may be a few unexpected issues while we iron out the kinks and learn how to use the system ourselves. The aim is for us to be able to troubleshoot those quickly and help you navigate your experience should you need a hand.

We put the annual membership subscription renewals on hold while we implemented our new platform.

If your membership began anytime prior to July 2021, your membership is now due for renewal and you will shortly receive a renewal notice from our new system.

If you have not received a membership renewal notice, please let us know.

You can email us at membership@ruralwomennz.nz or phone us on 0800 256 467. We are here to help and always enjoy a catch up with Members anytime. For Members who usually receive their invoices in the mail, keep an eye out for them as they shouldn't be too far away. All payment details will be included on the invoice.



Strengthen
Support
Connect

National Conference 2023

The National Conference Organising Committee is looking forward to presenting the event in Christchurch this year. After two false starts due to COVID-19, the incredibly patient members of the Committee have planned a fantastic three days in Christchurch.

The venue will be the Rydges Latimer in central Christchurch. The equally patient team at the Rydges, who have worked with us over the past three years, are looking forward to finally welcoming us. RWNZ has secured a preferential block booking at the Rydges for National Conference delegates. You are able to book your accommodation online at: www.rydges.com/private-page/rural-women-nz-conference-2023/

Alternatively, you can call the Reservations Desk at the Rydges on (03) 379 6760 or 0800 176 176.

The Opening Ceremony will commence at 2pm on Thursday, 23 November with an excellent afternoon and evening programme to follow. The RWNZ Annual General Meeting will be held during the day on Friday and this year's NZI Rural Women NZ Business Awards Dinner and Ceremony will take place in the evening from 6pm.

We will return to the National Conference programme on Saturday with a lively panel discussion followed by a Laughter Workshop. The Conference will close at 12pm.

One of the features of this year's Conference is a range of optional tours and activities offered to explore Christchurch and surrounds either side of the official programme. This is a wonderful opportunity to learn more about the revitalisation of the city.

Registration forms will soon be available on the RWNZ website at <https://ruralwomennz.nz/national-conference-2023/>

If you would like a registration form for the National Conference mailed to you, please call the National Office on 0800 256 467.

NATIONAL CONFERENCE PROGRAMME

Thursday, 23 November

- 12.30pm Registrations open
- 2.00pm Official opening
- 3.30pm Afternoon Tea
- 4.15pm Guest Speakers
- 5.30pm Drinks
- 6.00pm Meal/Evening Entertainment

Friday, 24 November

- 9.00am Registrations open
- 9.30am RWNZ Annual General Meeting
- 10.30am Morning tea
- 11.00am AGM resumes
- 12.30pm Lunch
- 1.15pm AGM resumes including National Speech Competition
- 2.00pm Afternoon Tea
- 2.30pm Awards Showcase
- 4.00pm Free time
- 6.00pm NZI Rural Women NZ Business Awards 2023

Saturday, 25 November

- 9.00am On The Couch Panel discussion
- 10.30am Morning tea
- 11.00am Laughter Workshop
- 12 pm Conference closes

WELCOME TO CHRISTCHURCH

ACTIVITIES FOR CONFERENCE ATTENDEES

INTERNATIONAL ANTARCTIC CENTRE

An interesting mix of interactive activities designed to simulate life in Antarctica. Located near the Christchurch Airport. Cafe onsite. Open every day of the year 9a.m. - 4.30p.m. www.iceberg.co.nz



NEW REGENT STREET PRECINCT

Opened in 1932, New Regent Street is Christchurch's only complete heritage streetscape. With beautiful Spanish Mission architecture and a distinctive pastel colour scheme, it's long been popular with locals and tourists alike. 5-10 minute walk from Rydges Latimer (where you could also catch the tram). www.newregentstreet.co.nz



CHRISTCHURCH TRAMWAY

Narrated rides through the city on vintage trams with hop-on and hop-off privileges at several places - unique experience learning of the history and also the restoration of the city. Hop-on within 5 minutes of Rydges Latimer. Fullcircuit is 50 minutes. Hours: 9a.m. - 5p.m. www.christchurchattractions.nz

CHRISTCHURCH TRANSITIONAL CATHEDRAL

5 minute walk from Rydges Latimer. Open Monday - Saturday 9a.m. - 4p.m. Sunday offers services at 8a.m. and 10a.m. www.cardboardcathedral.org.nz



CHRISTCHURCH GONDOLA

Take in the spectacular 360-degree views and see Christchurch from a different perspective; gaze at the Southern Alps, sprawling Canterbury Plains and the sparkling waters of Pegasus Bay and the Pacific Ocean. Open daily from 10a.m. - 4p.m. (Booking is advisable). www.christchurchattractions.nz



PUNTING ON THE AVON RIVER

Admire the beautiful Botanic Gardens on an authentic Edwardian Punting Tours. Departs from Antigua Boat Sheds. www.christchurchattractions.nz



RIVERSIDE MARKETS

Market is an enclosed fresh farmers' market and vibrant, boutique shopping environment in the heart of the Christchurch CBD. www.riverside.nz



CHRISTCHURCH BOTANIC GARDENS

Several options available, including a guided tour of the Botanical Gardens in an all-weather electric shuttle, 10am-3:30pm daily. www.ccc.govt.nz



TURANGA (CENTRAL LIBRARY)

At nearly 10,000 square metres, Turanga is the largest public library in the South Island.

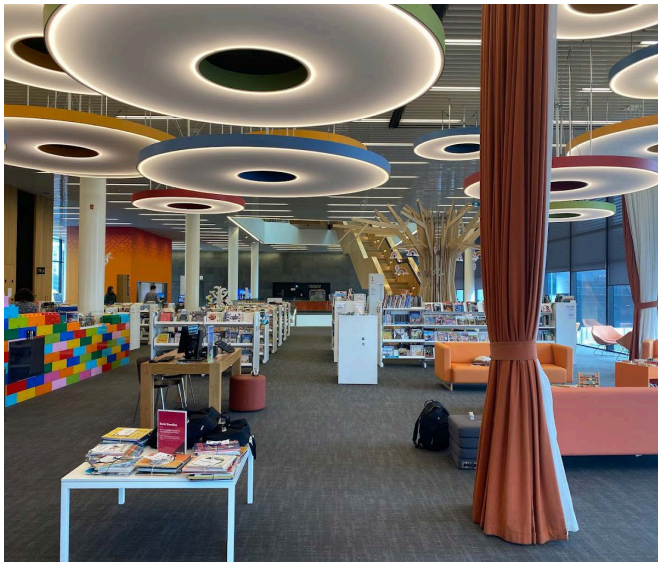

RICCARTON HOUSE AND BUSH

A unique New Zealand heritage site consisting of two historic buildings, flanked by beautiful open parkland and ornate gardens, bordered by the River Avon and set against extensive native bush forest featuring Kahikatea trees up to 600 years old. A tranquil 12-hectare reserve just 3.5kms from the City Centre. Guided heritage tours of Riccarton House operate every day at 2pm (except Saturday). www.riccartonhouse.co.nz



CHRISTCHURCH ART GALLERY TE PUNA O WAIWHETU

Substantial art collections and also presents a programme of N.Z. and international exhibitions. Open 10 a.m. - 5 p.m. daily. www.christchurchartgallery.org.nz



AIR FORCE MUSEUM OF N.Z.

The Air Force Museum of New Zealand had its origins in the RNZAF Historical Centre, established at RNZAF Base Wigram in 1976. This was a small-scale, part-time venture, until 1981 when a formal Air Force Order established the RNZAF Museum as an official Air Force unit, staffed by uniformed Air Force personnel. www.airforcemuseum.co.nz





From the Board Table

Following on from the two cyclones earlier in the year, many regional areas in the North Island are continually being impacted by heavy rain events. Our farm at Rere in Tairāwhiti has had 1300mm in the first 6 months of the year, more than our annual average rainfall and way too much rain for our hills to cope with.

With these challenges come opportunities for Rural Women NZ Members to support those areas affected. Our Mission of strengthening, supporting and connecting people and communities is so very reflective of how our amazing Members shine in times of adversity.

There has been so much aroha and support from all around NZ through parcels of baking, dry goods, knitting and women's health items. These items have been distributed by RWNZ Members, industry bodies and friends in the regions.

Thank you, thank you, thank you to all who have supported with donated goods and funds to the Adverse Events Relief Fund. Thank you also to Sharron Davies-Martin and the committee working on the high number of applications RWNZ has and continues to receive (see Adverse Events Relief Fund report in this Express)

October 2023 will see the Incorporated Societies Act 2022 legislative change come into effect. The Board and RWNZ's solicitors are reviewing the RWNZ Rules (Our Constitution) and By-laws to ensure we meet our legal obligations. Once the review process is completed, recommended changes will be provided to Members in the Annual General Meeting documentation.

Based on work completed in early 2022 the Board initiated a Policy Review Committee. A revolving, three year review process for all policies has been implemented. The process ensures the Board is meeting its governance and legal obligations on your behalf.

The external policy area has been quieter of late after a barrage of activity over the past 5 years. The Board would like to thank member and policy consultant Sue Trezise for providing policy support to monitor and advise RWNZ in this critical area and ensure we represent Members in any issues arising. An update of the work we have been doing in relation to external policy is included in the National Office report.

We are extremely pleased to welcome those Members who have expressed interest in being involved in the Policy Action Advisory Groups. This initiative is aimed at providing a regional member driven view to feed into RWNZ public

policy work. There are still a couple of places on some PAAGs so contact the office for more information.

By the time you receive this Express, the Pae Ora Healthy Futures strategies on which we submitted and met with Manatū Hauora Ministry of Health officials will have been released.

Following are the six strategies:

- The New Zealand Health Strategy
- Pae Tū: The Hauora Māori Strategy
- Te Mana Ola: The Pacific Health Strategy
- The Health of Disabled People Strategy
- The Rural Health Strategy
- The Women's Health Strategy.

The RWNZ 2022-2027 Strategic Plan Business Systems and Environment pillar is an integral part of overall strategy objectives, providing the basis for an efficient and effective operations system to support Members today and in the future (see website for details).

With this in mind our staff team undertook a comprehensive technology review to ensure we are able to support Members effectively.

As a result, the following initiatives have been undertaken, with more detail provided in the operations report:

- Database upgrade with the ability to provide future website integration
- Transitioning operations and archive files to the secure online software platform Microsoft Office 365. This will provide greater security of our data while building additional collaboration opportunities for Board, staff and the regional leadership team.

The Policy Manifesto has been reviewed by the Board and by the time you receive the Express will be with Members to provide feedback. The Board will meet with each political party in August to discuss the content of the RWNZ Manifesto in greater depth.

The Board is looking forward to joining the Regional Leaders in early August for their annual hui. This hui provides time for Regional Leaders to discuss challenges and opportunities with the Board; provide continuation of leadership training; and for us to build together a strong and effective team for the benefit of all current and future Members.

Ngā mihi, Sandra

Adverse Events *Update*

The Adverse Events Relief Fund has been in high demand since the events of January and February with an unprecedented number of applications received from those regions impacted by Cyclones Hale and Gabrielle, and subsequent weather events.

Between February and June 2023, over \$113,000 has been donated to the Fund. This has been a combination of generous donations from an anonymous benefactor, fundraising events by both Rural Women New Zealand groups and other groups that support our mahi, and the generosity of our Members.

Around \$120,000 has been paid out in Adverse Event Grants over that period and as at the end of June, the balance of the Fund was just over \$44,000.

We encourage Members to continue their fundraising efforts to support the Fund and we are also thankful for the ongoing regular support from an anonymous donor.

Although Adverse Events Grants are confidential, we wanted to give you a sense of how these grants are assisting those who receive them.

Many have been displaced from their homes with uncertainty for some around when, or if, they may be able to return. Those who have not been displaced are still facing significant disruption with many realising they were under-insured or having their work, and therefore income, affected following the Cyclones. Many parents are struggling with this whilst managing the mental load of the trauma and upheaval and also their children's distress and uncertainty.

Our grants assist with the inevitable additional costs that people are facing and although the grants are capped at

no more than \$1000, the feedback we get from recipients regarding the difference this makes is humbling. In particular, knowing that they are not forgotten and that their loss is acknowledged is often as important as the funds received. Here are some messages we have received in thanks that express this:

"Thank you very much to you and the whole RWNZ whānau."

"Wow thank you so much - the generosity and support of RWNZ is hugely appreciated. It's a long process ahead of us, but with slow and steady steps we will get there."

"Oh thank you so much! You have no idea how much this makes a difference."

"Thank you again, all of you. There are some true angels operating out there right now and on behalf of everyone struggling; our deepest gratitude."

The generosity of our Members has also been apparent in the wonderful parcels and packages that have been sent to both Hawke's Bay and Tairāwhiti. Thank you to those who have contributed to this and to the Regional Leaders and Committees who have coordinated this support.

In the words of our National Board Chair, Sandra Matthews, who is based in Tairāwhiti :

"It is wonderful to feel the aroha from all over the country from RWNZ leaders and Members."

Our Members on the ground in the affected regions are keeping us updated on the best ways to support the recovery efforts and the message for now is 'Keep doing what you are doing.' It is much appreciated and is making a difference.

Baking Up a Storm

This epic fundraising event took place in Region 6 Greater

Waikato and was delivered by Soil Sisters - a fabulously talented group of Waikato women chefs, growers, famers and foodies.

Baking Up a Storm took place on Friday, 24 March at the Horahora Memorial Hall and featured a bake-off and cake auction, a quiz, raffles, music and a BBQ feast. Proceeds from ticket sales, the auction and raffles were split 50:50 between the RWNZ Adverse Events Relief Fund and The Kōanga Institute in Wairoa.

Legendary baker Allyson Gofton was on hand to judge the cakes before they were auctioned. The evening was a wild success with nearly \$15,000 raised for the two charities.

Just goes to show that you can have your cake and eat it too.

Photos credit: @Bloomandfolk



Triple F Challenge

The Triple F Challenge Organising Committee decided that the proceeds of any fundraising in Taupō would be used to help people impacted by Cyclone Gabrielle. The result was a whopping two full vehicles of non-perishable goods which were transported to Sandra Matthews for distribution via a network of volunteers to people in Tairāwhiti. This part of the country has continued to experience extreme weather and many communities have been cut-off numerous times. Some of the parcels have been delivered by 4WD or helicopter or by cross-country trekking.



Ladies Lunch

The Ladies Lunch provided an opportunity for about 40 women from across northern Waikato who had been affected by the weather events across their region. It was a chance for these women to get away from their farms, enjoy a meal together and some time to themselves. The lunch was organised by the Rural Support Trust and local RWNZ Members.



Reaching out from the South Island

The South Island Regions have been supporting the post-cyclone recovery efforts in numerous ways. In addition to fundraising for the Adverse Events Relief Fund and sending donations to support the work on the ground by our Members in the impacted areas, vast amounts of supplies have been transported from the South Island north.

Our South Island Members have plenty of experience in flood recovery and their support is hugely appreciated.

You may have recently seen a news item on Kate Cullwick, our Emerging Business Award winner. The TV crew recorded Kate and Prue as they delivered shoebox gift packages sent from Region One. The recipients of these parcels have been incredibly touched by these gifts.

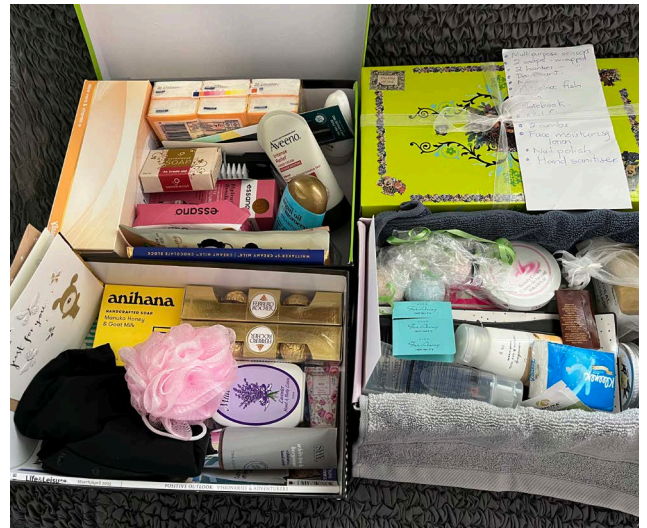

*Some of the beautiful gift boxes from Region One.
Thank you to Jocelyn McIraith for this photo.*

Adverse Events Relief Fund

The Rural Women New Zealand Adverse Events Relief Fund (AERF) was established to provide assistance to individuals, groups and communities in need after adverse events and natural disasters.

To help grow this fund, we are selling RWNZ's pure wool, New Zealand-made **Aftersocks**, the proceeds of which go directly to the AERF.

These are available online at www.aftersocks.nz or from the National Office.



Alternatively, donations can be made directly into the Adverse Events Relief Fund by bank deposit to the following account:

Account Name: **Rural Women New Zealand**

Bank Account: **06-0501-0778590-00**

Ref: **AERF**

Policy Action Advisory Groups (PAAGs)

Our thanks to all those Members who have so generously offered their time and expertise to the PAAGs. We are delighted to have the benefit of your considerable skills and experience.

Each PAAG is having their first meeting in July/August and we will be updating Members on the work they are doing in the next Policy Newsletter and in the October Express.

We currently have some places still available if you have an interest in one of these policy areas and just haven't got around to submitting your Expression of Interest (EoI).

To ensure the PAAGs have representation from around the country, there is the opportunity for one representative from each Region on a group. If there is a policy area that you are interested in that does not have a representative from your Region, we would love to hear from you.

You can find the information about the PAAGs and the Expression of Interest form here. <https://ruralwomennz.nz/policy-action-advisory-groups-paags/>

PAAG	Name	Region
Community and Social Inclusion		
Board Convenor	Sharron Davie-Martin	
	Rachel Kain	Region 2
	Serena Lyders	Region 1
	Sarah Vallance	Region 4
	Liz Pennington	Region 5
Business and Connectivity		
Board Convenor	Claire Williamson	
	Roselle O'Brien	Region 1
	Colleen Sheldon	Region 4
Education		
Board Co-Convenors	Emma Higgins & Gill Naylor	
	Marianne Farrell	Region 4
Environment and Land Use		
Board Convenor	Emma Higgins	
	Rebecca Hyde	Region 3
	Marja Fannin-Meeter	Region 6GW
Health		
Board Convenor	Sandra Matthews	
	Mary Nowotarski	Region 5
	Bronwyn Main	Region 6GW
	Steff Cresswell	Region 4
	Barbara Earl	Region 1
International		
Board Convenor	Gill Naylor	
	Victoria Beckwith	Region 4

WORKING IN WOODCUT RURAL CALENDAR 2024

If you are looking for the perfect gift to send to friends and family overseas, then this is great option for you.

This beautiful calendar features twelve unique woodcut images which provide a beautiful perspective of life in rural Aotearoa New Zealand throughout the year. The striking original artwork has been created by Carol Teutscher from the Fordell Mangamahu Branch in Region 4.

All proceeds from the sale of these calendars will support the Branch's education bursaries for rural children.

The calendar is A4 size, so it fits nicely in a large size envelope for posting. At \$25 + delivery (inc GST), these calendars really are something very special and unique.

To place your order, or if you have any questions, please email: WhanganuiRWNZ@gmail.com



LAST POST

WORKING IN WOODCUT
RURAL CALENDAR 2024

Leptospirosis Update

RWNZ's support and collaboration with Massey University to research leptospirosis started in 1975.

For the organisation's Golden Jubilee year, it was decided that the National Project would be the establishment of a Chair of Research into Leptospirosis at Massey University. Leptospirosis was little understood at that time but the consequences of contracting the disease were devastating for many rural families.

The aim was to raise \$15,000 to fund this Chair and the necessary research but that target was easily met and \$35,000 was dedicated to the project. In 1979, the development of a vaccine was announced at the National Conference.

That marked the beginning of our ongoing support for research to better understand and therefore reduce the number of infections. The collaboration with Massey continued during the 1970s and 1980s and approximately \$150,000 was raised to fund further research; the production of dozens of reports, two PhDs (both women) and most importantly, a reduction in cases. The connection and support continues today.

Massey University continues to update RWNZ on research

progress and findings and we have just received the latest results summary from the funding approved in 2018 titled "Emerging Sources and Pathways for Leptospirosis: a paradigm shift - Summary of study results (HRC #18-239)"

This document is available on the RWNZ website at: [https://](https://ruralwomennz.nz/wp-content/uploads/2023/07/Summary-of-results_Lepto-2023.pdf)

ruralwomennz.

[nz/wp-content/uploads/2023/07/Summary-of-results_Lepto-2023.pdf](https://ruralwomennz.nz/wp-content/uploads/2023/07/Summary-of-results_Lepto-2023.pdf) or by phoning the National Office to request a printed copy.



RWNZ National Board Elections 2023

Elections will be held for the following National Board positions this year:

Pursuant to the Rules and Bylaws of Rural Women New Zealand Incorporated, elections will be held for the following Board positions this year:

- North Island Board Representative x 1
- South Island Board Representative x 1

North Island Board Member Sandra Matthews will have completed her first term of two years and is eligible for nomination for a further term. South Island Board Member Sharron Davie-Martin will have completed her second two-year term and is also eligible to stand for a further term.

Sandra and Sharron have indicated their availability for nomination for a further term.

A summary of the requirements and the desirable skills and attributes for each role, along with reference to the relevant governing documents and policies can be viewed on the RWNZ website or a copy obtained from National Office

In addition to the information provided, Members who are considering standing for a Board position are welcome to contact our Chief Executive, Gabrielle O'Brien to discuss any questions regarding the roles.

Nomination forms for the available positions will be sent by Members Advisory and are included with this Express.

The closing date for nominations for all positions will be **Friday, 1 September 2023.**

Following the receipt of nominations, the National Office staff will prepare, as appropriate, voting papers and candidate information which will be posted to Members on **Friday, 15 September 2023.**

The closing date for receipt of completed voting papers at National Office will be 5pm on **Friday, 27 October 2023.** The votes will be counted by the Returning Officer and the election results will be declared at the Annual General Meeting to be held in Christchurch on **Friday, 24 November 2023.**



National Office Report

Who would have thought that it was a year ago that the National Office team moved to the “new office?” We are well settled in and welcome Members visiting when you are in Wellington. We can offer wi-fi and working space, a cuppa and baggage holding services so do please call in if you are in Wellington even if just to say hello.

July marks the beginning of the new financial year and the beginning of the annual reporting for the last financial year. Forms for those who are completing reporting for branches and other groups have been circulated. Janet, our Finance Coordinator, has also been offering drop-in Zoom sessions to help with any questions or assistance you may need in filling these forms out. Information on these sessions has been sent out electronically with a link to register. If you can't make a session, need a form or have questions, please contact accounts@ruralwomennz.nz or call the office on 0800 256 467 and Janet will be able to assist.

July is also Membership renewal month for most of our Members. This year we will be using our new Membership management software to send out notifications. One of the reasons for using this new software is to address issues that had arisen with the previous platform. We will be working hard to make this transition as smooth as possible for Members. This software will also support our strategic objectives around the way Members can engage with us and with each other. This includes the opportunity to update our online communications to you and access to the Members Zone of the website in response to your feedback from the Communications survey. A summary of the feedback received in this survey is included with this Express.

The new Policy Advisory Action Groups (PAAGs) have also been launched in recent months. These replace the Portfolio Hubs which bring a fresh new approach to RWNZ's public policy work. PAAGs consist of RWNZ Members working together to ensure the voice of rural women and rural communities are heard and not forgotten when legislation and regulations are being changed and considered. We will continue to build the Membership of these groups and welcome ongoing Expressions of Interest. Information on this process can be found on the RWNZ website.



Gabe, Claire, Sandra and Colleen at E Tipu.

Policy work in the last few months has included discussions with the Ministry of Health regarding our submission on the Women's Health Strategy and follow up discussions regarding the Rural Health Strategy as well as further engagement with the Independent Electoral Review Panel in response to our submission on proposed electoral reforms. We also received a range of coverage in the media regarding increased prices for postal services and the challenges this presents for rural communities particularly those without reliable, consistent connectivity.

Our draft Public Policy Manifesto has also been circulated for feedback and input and we welcome your comments.

In addition, Claire Williamson, our Connectivity and Business PAAG Convenor, spoke at the Rural Connectivity Symposium regarding digital connectivity challenges and opportunities and our Chief Executive, Gabe O'Brien spoke at the Women in Grain and Seed Conference on issues facing rural women and the work of Rural Women New Zealand at both a national and local level.

We are looking forward to welcoming the Regional Leaders to Wellington in early August for the annual Leadership Hui. This is a great opportunity to work together on our strategic objectives and to share information and build connection.

Other priority areas of work in recent months has included processing many Adverse Events Relief Fund applications.

The Adverse Events Relief Fund committee has put a huge effort into considering these applications and it is wonderful to be able to support their efforts.

We have also enjoyed supporting the range of work happening around the Regions whether that is larger events like Triple F in Taupo or Regional Conferences or smaller local events.

Thanks to those from Region 1 and Region 6 Greater Waikato for their warm welcome to Gabe and/or Board Members at their recent Conferences. By the time you read your Express, thanks will also be due to Region 6 Taranaki and Region 2 Canterbury who hold their Regional Conferences this month.

Preparations are well underway for the National Conference, Annual General Meeting and Business Awards in Christchurch in November. It will be fantastic to finally get to Christchurch after two COVID-19 enforced postponements.

Entries are currently open for this year's NZI Rural Women NZ Business Awards and the Activator Programme is also in progress at present. Preparations for RWNZ's Centennial celebration are also underway. We look forward to the opportunities these events provide to both celebrate the accomplishments and work of rural women as well as the chance to get together and connect.

Below: Gabe, Sharron and Emma at Fieldays



Conference & Events Highlights

June and July is event season for the Primary Sector with National Fielddays, E Tipu – The BOMA Agrisummit and the Primary Industries Summit and Awards all happening in quick succession.

As well as being a great opportunity to connect with people across the Primary Industries sector, these events provide a chance to hear from a variety of voices and perspectives on what is likely to shape both the sector and rural communities over the short and longer term.

Some consistent themes across all events was the heightened awareness of climate change imperatives following this year's weather events and the ongoing development of scientific innovation and digital tools to enable new practices for the future. The challenge of scalability is still one to be addressed in many areas. An emerging conversation regarding the place of biotechnology and a desire for a further national conversation about the place or otherwise of gene technology featured as well as the importance of understanding consumer trends and demands.

There's too much to compress in a single page but here's a flavour of the diverse topics covered.

Each year at **Fielddays**, KPMG launch their Agribusiness Agenda. This year the report was titled "Energising a World of Anxiety" noting that "...there are massive opportunities in front of Aotearoa's food and fibre sector. However, there is a deep sense that people are struggling to connect to what the future looks like and there is a need for a boost of hope and energy to move forward."

As well as providing insights into the perspectives of current and emerging leaders in the sector, the agenda highlighted 4 key themes:

- Leading the unconverted (*leading on from the anxiety to hope theme*)
- Stepping up Innovation (*connecting innovation with the regulatory framework and investment in infrastructure*)
- Investing in defensible trust (*picking up themes of collaboration for good regulation*)
- Feeding the Five Million (*highlighting the priority of emerging leaders*).

More information on these themes and a full copy of the report are available here: <https://kpmg.com/nz/en/home/insights/2023/06/2023-agribusiness-agenda.html>

At the **E Tipu - the Boma Agrisummit**, there were a number of thought-provoking speakers from New Zealand and overseas focussing on innovation both in the lab and at the start-up phase. Sometimes this future focus can seem overwhelming so it was wonderful to hear a presenter from Food Waste Champions 12.3 (nzchampions123.org)

talking about the growing number of options for consumers to do their bit towards reducing waste for environmental, economic and social benefits.

Practical tools include:

- The Foodprint App that connects users to eateries with surplus and imperfect food that is available at a discount
- Savey Mealmaker – The Pak n Save web tool that allows users to enter a minimum of three ingredients lurking in the fridge and generates a recipe. If they rate it as delicious, users can then save and share the recipe.

Alongside innovations in managing by products (e.g. onion skins into onion powder) and the growth of options like "Wonky Boxes" that source fruit and vegetables from local growers that would have gone to waste, the presentation highlighted a number of ways that rural and urban New Zealand can work together to reduce food waste. More information is available from: nzchampions123.org

A particularly interesting presentation at the **Primary Industries Summit** was one from Distinguished Professor Emeritus Paul Spoonley who spoke on workforce issues and future population trends in Aotearoa New Zealand. He noted the ongoing challenge for the Primary Sector and regional New Zealand with an ageing population and declining fertility.

Predictions for the future were that any population spikes are likely to be associated with increases in immigration and we can expect to see ongoing urbanisation with a concentration of population in the top of the North Island with Auckland experiencing half of future population growth.

For rural and regional New Zealand, it was expected that main regional towns would grow although this growth will slow and there is likely to be continued decline in overall regional and rural populations.

He noted that though the population is ageing, over one quarter of New Zealanders remain in the workforce after 65 and this is a trend that may assist the Primary Sector.

Despite these sobering predictions, Professor Spoonley identified a number of opportunities for the future including:

Understanding these future trends at both a regional and sector level to inform future approaches

Maintaining local access to core services and infrastructure

Developing immigration strategy at the sector or regional level (with Ashburton highlighted as a good example of a region doing this)

Understanding and embracing the opportunity provided by a more diverse population.



*Entries
open
now!*

National Competitions

Writing Competitions

Entries are now open for the Marlborough Short Story Competition and the Olive Burdekin Prize for Advanced Writers 2023. The title and theme for this year's competitions is **"Gardens/Gardening."** Entrants may include a subtitle.

Marlborough Short Story Competition

This competition is open to all amateur writers who are Rural Women New Zealand Members and who have not won this competition in the previous two years or had their writing published - apart from contributions to newspapers or in the RWNZ Express magazine. The story should not contain more than 1000 words, with a minimum of 600 words. The winner will be presented with the Marlborough Tray and a book voucher. Rural Women New Zealand thanks the Marlborough Provincial for sponsoring this award and managing the competition.

Olive Burdekin Prize for Advanced Writers

This section is for Rural Women New Zealand Members who are not eligible to enter the Marlborough Short Story Competition. They are either previous first place winners in the past two years or have had articles or books published. The story should not contain more than 1500 words, with a minimum of 1000 words. Judging will be based on 'Short Story' form but may be based on historical memories.

The winner will be presented with the Olive Burdekin Prize. Prize money for this award is sponsored by Olive Burdekin of Region 3 and Rural Women New Zealand thanks Region 3 for the management of this competition.

Here are the entry criteria for both competitions:

- The number of words must be written in the top left corner of the first page.
- The entrant must state which competition their entry is for on the first page.
- If the number of words in the entry is not printed on the first page or the category entered is not specified, the entry will be disqualified.
- Stories must be written or typed on one side of the paper only.
- Envelopes or emails clearly indicate which competition the enclosed or attached entry is for.
- Please do not put your name on the entry itself.

The closing date for entries for both competitions is **Thursday, 31 August 2023.**

Entries should be posted to Mrs Jennifer Wiese, 25 Tirimoana Terrace, RD1, Picton 7281 or sent by email to: jen.wiese@icloud.com

Speech Competition

The topic for this year's Speech Competition is:

**“Things our mothers taught us,
things we'll teach our children.”**

This year's competitions for the Tarrant Bell and Tutaenui Bell will take place as part of the Annual General Meeting programme in Christchurch on Friday, 18 November.

For more information on both competitions and the judging criteria, please visit the RWNZ website or call National Office on 0800 256 467.

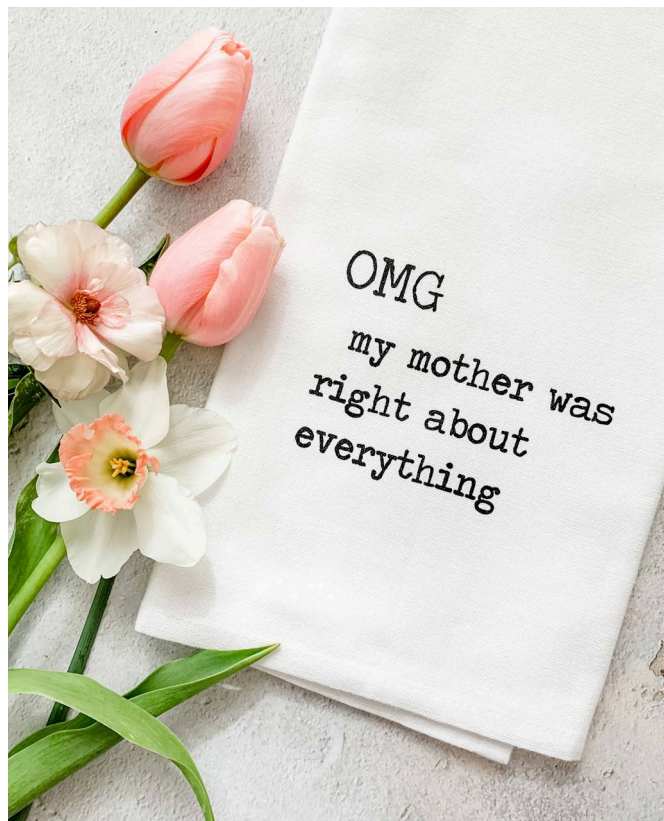

Cora Wilding Trophy

This year's craft competition for the Cora Wilding Trophy is a **Christmas Decoration**.



Wool Competition

This year's item for the Wool Competition is a **Woollen Toy**.

The toy must be safe for pre-schoolers. Decorations (eyes etc) are to be sewn or embroidered or use felt etc. No buttons may be used. Following the competition, the toys will be donated to Canterbury Plunket with the permission of the entrants.



Welcome to New Members

Samantha Titze, Region 2
Kelly Atherton, Region 6GW
Natasha Klarwill, Region 2
Sherice Hodgson, Region 6GW
Noeline Jeffries, Region 6GW
Jacinda Poland, Region 5
Katrina O'Reilly, Region 1
Natalie Priestley, Region 4
Kate Burgess, Region 1
Leeann Morgan, Region 6GW
Nadia McClelland, Region 2
Carmen Smith, Region 4
Angela McLeod, Region 4
Heather McGregor, Region 4
Kathryn Wright, Region 1
Greer Paterson, Region 2
Shayna Ward, Region 4

Virginia Quartel, Region 7
Steff Cresswell, Region 4
Gaylene Kellick, Region 4
Janette Carmichael, Region 1
Liza Vass, Region 3
Debbie Early, Region 3
Chris Bogers, Region 1
Kylie Brown, Region 4
Emma Andrew, Region 4
Fiona Duley, Region 4
Karla Gichard, Region 6TK
Anne Mackersy, Region 1
Carolyn Nicol, Region 4
Kiri Roberts, Region 2
Jan Wards, Region 1
Fiona Mackay, Region 3
Chrissy Parkes, Region 3

Sammy Garrett, Region 3
Moana Hancock, Region 6TK
Dot McDonald, Region 1
Margaret Pidwell, Region 4
Cala Paenga, Region 1
Debbie Kelliher, Region 2
Jan-Marie Stevenson, Region 1
Nicola Johnstone, Region 1
Laura Morrison, Region 4
Carmen Andrews, Region 1
Teena Jelsma, Region 3
Elle Mitchell, Region 2
Ross Townshend, Region 6GW
Michelle Payne, Region 3
Amanda Cornwall, Region 5
Elizabeth Thomas, Region 2

Contestable Fund Grants

Have you got a great idea for an event or project which will attract new members to RWNZ?

If the answer is yes, then you may be eligible for a grant from the Contestable Fund to put your plan into action.

Here's an update on recent and ongoing projects:

Made in Stirling

The Made in Stirling series of monthly workshops provide a crafting good time. The last workshop was on cake decorating. It was clearly a moo-ving experience for the participants and the results look delicious.



Upcoming workshops:

30 July: Driftwood creation – design and make your own rustic mirror using driftwood and other bits and pieces

27 August: Dried flower wall hanging

24 September: Learn to knit – make your own handmade cotton dish cloths and enjoy a coffee and chat while you do!



Rural Skills & Empowerment Days

Region 5 Rimaniui held the second of three informative sessions aimed at building skills for rural women at Pyes Pa Hall on Saturday, 24 June. This session brought together a fabulous range of speakers and experts to help participants get the best out of their gardens.



Bring Balance Group

Region 7 is running a Bring Balance Group which offers participants weekly sessions via Zoom. The course offers an opportunity for women to develop skills to cope with the challenges of life – take time to pause, reflect and set intention.

The course has been specifically developed by RWNZ Member and holistic life coach, Maureen Buchan Reid and Region 7 Regional Leader, Heather Sorensen.

Triple F

The Organising Committee invited local Taupō based women to join the Triple F Saturday Night Programme. Twenty-four non-members came for dinner, met Activators Kate and Miki and listened to guest speaker Shaz Dagg. The evening was hugely successful and a wonderful opportunity for the local guests to learn more about RWNZ.

If you would like to talk over an idea or find out more, call Gabe or Lisa at National Office.

RWNZ Centennial

2025-2026

In two years' time we will all be preparing for the opening event celebrating Rural Women New Zealand's 100th birthday. Celebrations of all sorts will take place throughout the centenary year which will run from the end of July 2025 through to July 2026.

The Centennial Committee has met by Zoom over the past few months to draw together many of the proposed projects and initiatives. Thank you to everyone who contributed to this process.

Some of the celebrations will be one-off events while others will be lasting testaments to the past, present and future of WDFU, WDFP and RWNZ. Work is now being undertaken on scheduling the year's timetable to ensure as many Members as possible can take part in local, regional and national events.

The opening will be a hybrid event which means that it will be held in several locations simultaneously across the country and they will be linked together by livestream coverage. We used this model for the Business Awards in 2021 when COVID-19 restrictions meant we ran Awards ceremonies in three separate locations and linked them together. If you think back to what the old Telethons were like, it will be a little like that but smaller!

Having some smaller get-togethers across the country will make it easier for Members of all ages and situations to take part in a very special day.

At the other end of the year, the closing event in July 2026 will be an opportunity to take stock as we turn our attention to the future.

Some of the centennial projects have long lead times and they are underway already.

Centennial Rose project

The Centennial Rose project, initiated by Region 4, is now well advanced and the rose will be available for purchase during the centennial year. We are extremely pleased to announce your opportunity to be an integral part of this project by coming up with the perfect name for the rose. The Centennial Rose Naming Competition is now open (see next page for details).

Centennial Book project

The other project with a very long lead time is the production and printing of a Centennial Book. Previous histories have been produced to mark the

organisation's 25th, 50th, 60th and 75th anniversaries and we want to produce a very special record for the centenary.

The Centennial Book Writing Competition has been hugely successful and the Committee sincerely thanks everyone who shared their stories. Our book will be all the richer for them.

Centennial stamp project

Preliminary work and an expression of interest has been lodged with NZ Post for the inclusion of an RWNZ Commemorative themed stamp in the 2025/26 issues.

Commemorative regional events

Funding has also been allocated for local/regional events or commemorative installations during the centennial year. This will provide more opportunities to include as many Members as possible and to have activities that are tailored to each Region.

RWNZ's heritage of charitable giving back will be recognised by a National Project focused on mental health and wellbeing during the centennial year.

This programme offers something for everyone. It aims to acknowledge the range of interests and activities enjoyed by Members throughout the country and draw on the incredible diversity of skills and experience in the organisation.

Centennial Working Groups

To help us achieve our goals, the Committee has created five Working Groups which will focus on specific aspects of the programme.

These are:

- Sponsorship and grant applications
- Centennial Book
- Opening and Closing events
- National Project
- Promotions.

The Centennial Committee is seeking members for these five Working Groups. This is a wonderful opportunity to work on a once in a lifetime project.

There are lots of reasons why women have joined and continue to join RWNZ and we warmly welcome you to use your skills and experience, or join one of these groups and gain some new skills and experience, and help us make our centennial celebrations an unforgettable year.



If you would like to join one of the Groups, please contact Lisa on lisa.thompson@ruralwomennz.nz or call National Office on 0800 256 467.

The Centennial Committee will be meeting again at the beginning of August to begin the next phase of planning and confirm the Working Groups.

Please don't hesitate to contact any of the Centennial Committee members with any questions you might have.

The Centennial Committee is:

Region 1: Pat Macaulay

Region 2: Bev Bagrie

Region 3: Emma Higgins

Region 4: Julie Perkins

Region 6 Taranaki: Margaret Vickers

Region 6 Greater Waikato: Bronwyn Main

National Board representative: Gill Naylor

National Office representative: Lisa Thompson

Centennial Rose Naming Competition

This is your opportunity to play a major part in our Centennial celebrations in 2025.

We have teamed with Whanganui's Matthews Rose Nurseries to breed a new rose, exclusive to us, to celebrate our past and our future.

The new rose is described as: "Floribunda rose displaying clusters of soft lilac hued blooms above a bushy growing, easy care plant with mid-green foliage. Repeat flowering. Fragrant. Height approx. 1.1m".

So, what is its name? If you have any ideas please send them to WhanganuiRWNZ@gmail.com along with your name, email/phone and Branch (if you have one).

It is open to all New Zealanders and you can enter as many times as you like.

The winner will have the privilege of naming our rose, to be sold nationwide, and will win one of the new roses, delivered, to anywhere in the country.

The judges will not have any knowledge of who submitted the rose name until after it is decided. Entries close **30 September 2023**.



A Centenary Celebration

To get us all in the mood for upcoming centennial celebrations, look at this fabulous photo of Ruihi Waldrom who reached this milestone birthday early this year.

Ruihi was a member of the Waimauku Branch and a highly valued RWNZ Member for 60 years.

Congratulations Ruihi!

Thank you to Dianne Gray for sending in this lovely photo.



Branch News

DORA THE DIGITAL BUS

Dora stands for Digital On Road Access and is a pale blue and white bus.

Dora is a 1985 Isuzu ex-school bus originally from Central Otago who has been fitted out digitally and can seat up to 10 people. She can go anywhere in NZ where there is a road as she has satellite internet and is self sufficient with solar panels on the roof. She offers FREE classes and is run by Digital Inclusion Alliance Aotearoa (DIAA) which delivers digital programmes in partnership with local libraries and organisations nationwide of which RWNZ is one. Our programmes were run by the Horowhenua Libraries, headed by Librarian Leala. We held very interesting and successful sessions and I urge all RW Regions to engage with DORA and a reminder it is FREE. It was an invaluable experience, solving people's digital problems, learning how to cope with scams and what local libraries have to offer.

People who visited Dora had digital problems, been scammed or didn't even have a computer but their problems were solved by the end of her visit to the Horowhenua.

Dora recently spent 9 days in rural Horowhenua visiting 9 areas starting at Manakau, Ohau, Waitare Beach, Shannon, Poroutawhao, Koputaroa, Tokomaru, Foxton and Foxton Beach. mainly parked in local hall car parks. Dora was well patronised throughout the district. I'm sure Dora would like donations as well to keep her going. Contact: 0800 463 422 or www.diaa.nz

Thank you to Pauline Masters for this report and photos.



MID-CANTERBURY

Cooking up a Treat

The Ashburton College Food Technology Laboratory was abuzz with the chatter and laughter of 29 students participating in the "Cook & Eat" school holiday programme held last Thursday (13 April 2023). The day was organised by Mid Canterbury Rural Women N.Z., with 14 tutors and 3 co-ordinators funded by the Ashburton District Council.

The programme was open to Primary School children, Year 5 to Year 8, who had a very busy day preparing and cooking morning tea, a two course lunch, which were eaten and shared with their tutors, and afternoon tea, which was taken home for the families to sample.

A great day enjoyed by one and all!

Thank you to Trish Small for this item.





HENLEY BRANCH

Friendship Day

Each year, for longer than I can remember, Henley Branch have been involved in an Annual Friendship Day. This used to be a shared event among the Branches in Otago. However, we now find we are the only surviving Branch in our area, subsequently we hold Friendship Day for invited kindred clubs and societies. It is also our main fundraising activity for the year.

This year we focused on the Country of Study, New Zealand, with very interesting speakers talking about our local area. Zelda Matheson gave us a very thorough and well researched insight on The Taieri Plains, quartering the area and the surrounding hills to show many facts and differences of which a lot were unaware.

The audience were then treated to our lovely nonagenarian member, Gwenda Holmes, who recited a long poem from memory. Gwenda spent her early years at Berwick on The Taieri. After lunch Ngaire Sutherland spoke of her time at Hyde on the Taieri Rail Trail. Ngaire used to run the Hotel and accommodation venues in the area and was a very

entertaining and informative speaker. She also is very much thanked for standing in at last minute, like a true piece of No 8 fencing wire, well used for farming emergencies. We were to have had The Taieri High School Kapa Haka group, who sadly had to cancel at the last minute due to Covid.

The afternoon finished off with an entertaining skit from our President, Fay Taylor and long time Life Member friend, Anne Murphy. Subject was Lawn Bowls and the misconstruction bowling terms can present. Another poem from Gwenda and donated raffles were then drawn, I am sure there was one for everyone in the room. Afternoon tea followed.

Summing up, another very successful Friendship Day. Participants were given Morning Tea, Lunch, Afternoon Tea and raffles to win. A very friendly atmosphere, full of snippets of information, not already known. Friendships were made and re-established.

Thanks to Marion McGuigan for this report.

SOUTHLAND

Women Walk the World

Published in Southland newspaper, written by Ben Tomsett

Women from around the world will be hitting their stride this weekend all for a good cause. Women Walk the World is a fundraising effort by the Associated Country Women of the World (ACWW) that has been going since 2012.

ACWW members from around the globe will be joining forces this Saturday to walk together while raising funds for the organisation, with the Southland stretch taking part in Queen's Park.

Rural Women New Zealand member Ann Irving has been helping organise and will partake in the Southland walk this weekend. She said raising money for the organisation was a cause that was important to her as the funds largely went to underprivileged rural women.

Next month, she will be travelling to Malaysia to attend a week-long conference where the different issues that affect women overseas will be discussed. "Our way of funding is the woman must request what they would like help with.



"It's micro financing, we're not into big money, but we are helping women and children to learn to look after their families, grow crops, and learn how to do it better and how to market them. A lot of these women are disadvantaged in a major way and teaching them to sew or some other way of making income for their families is a major help."

Mrs Irving said the walk was an easy way for local rural women to connect with each other while helping to fundraise for underprivileged women abroad. She said the walk wasn't just for women, but all people were invited to join. "It's all about being friends with people, connecting with people. And if people come from overseas, we'd love to see them and have them share some of their stories with us.

ACWW is a registered charity that exists to amplify the voices of rural women as well as connecting, mobilising and empowering.



Triple F Challenge Taupo 2023

The inaugural North Island Triple F Challenge was held in Taupō at the end of April. The Triple F Challenge Programme was created in Region One and has been held there regularly since 2007. Members of the North Island Organising Committee knew they had their work cut out for them to produce a worthy North Island version of this much-loved event. To meet this challenge, an Organising Committee which drew members from five Regions came together to deliver an excellent programme. Special thanks to Pat Macaulay from Region One who shared the benefit of her experience and expertise as an organiser of previous Triple F Challenges with the Committee.

Triple F celebrates Fun, Friendship and Fitness and holding the event centrally in Taupō made good sense especially given the wonderful range of activities available.

One of the underlying themes of this Triple F was a focus on resilience and wellbeing. The resilience of the Organising Committee was seriously tested in the lead up to the event. Several members of the Committee were directly impacted by the cyclones and were out of contact for many days and have been working to support their communities since the middle of February. There was also concern that the damage to roads would impede possible attendees reaching Taupō. Perseverance won out and the event proceeded.

One of the decisions made by the Committee as a result of the cyclones involved a fourth F (which is another hallmark of Triple F Challenges which is fundraising). The decision was made that any funds raised at the event would be donated to help those impacted by the cyclones. The Committee also decided to seek funding to enable women who had been affected by the cyclone or who had been tirelessly working to support others. A total of seven women were funded to attend giving them much needed time out. Thank you to Beef & Lamb NZ, Region 6 Greater Waikato Area Committee and the Adverse Events Relief Fund for making this possible.

The programme kicked off with a cruise on Lake Taupō on Friday afternoon which was followed by dinner and the first guest speaker, Liz Pennington.

The Committee also incorporated a promotional event to welcome non-members on the Saturday evening. Guests were treated to a fantastic evening at the Cossie Club which included a presentation by guest speaker Shaz Dagg.

Following breakfast on Sunday morning, Sarah Martelli of Strong Women, our incumbent Rural Health and Wellbeing Business Award winner, took the group through its paces.

And before they knew it, the three glorious days which had been filled with plenty of fun, friendship and fitness had come to an end. As for the fourth F (fundraising), two vehicles packed full of non-perishable supplies were despatched to Tairāwhiti, to be distributed to rural families in need.

The Triple F Challenge will return to the South Island next year and, before they had even left Taupō, this year's participants were planning their road trip south.



Tributes

Karen Attwood

Region 6 Greater Waikato is mourning the loss of Area Committee member Karen Attwood. As a third generation Member, Karen had grown up immersed in Branch, Provincial and Regional meetings, functions and events. With over 60 years of meeting to draw on, Karen was a fount of knowledge and always the first to be front and centre of any new initiative.

Karen was recognised with Life Membership of the Piako Waikato East Provincial having served firstly as Vice President and then as President for the last twelve years. Ill health had forced her to take a leave of absence from the role this year.

Karen was awarded a National Service Award this year. This honour was also bestowed on her mother in 2001.

Karen loved connection with other Members, was quick to bring song and music to any gathering and enjoyed the camaraderie of National Conferences and AGMs. She was never afraid to stand up and speak, challenge the remits, share her knowledge. She remains very much admired for what she has done and stood for in the organisation.

Hers was a life of Service Simply Given.

Thank you to Jenni Torrens and Bronwyn Main for the content for this tribute.



Farewell to Old Friends

Karen Attwood - Tauhei Branch - National Service Award and Life Member Piako Waikato East Provincial

Margaret Wards - Individual Member formerly of Wyndham Branch

Rural Women New Zealand would like to thank:

Premier Partner:



Partners:



MPI



Supporters:



COMMUNICATIONS SURVEY RESULTS 2023

Over December 2022 to late February 2023 we sent out a survey to members regarding our communications with you all. We wanted to capture: what works well, what we need to improve and to get some insights into support for different ways of communicating. In addition to being sent out electronically, a paper version was included with the December Express to ensure those who could not communicate via email had an opportunity to give input.

In total we received 116 responses. The survey therefore provides us with a useful snapshot of member feedback to inform our plans for future communications. We intend to undertake the survey on an annual basis so that we can monitor progress and also include ongoing member feedback in our communications approach.

Below is a summary of the feedback received. This month we are updating both our database and the tools we use for communications. These changes have been informed by the results of the communications survey. We have included some comment on what you can expect to see over the coming months as a result of these changes.

MEMBERS ADVISORIES (MA)

MA's are one of the most engaged with communication formats that we use. An overwhelming majority (**94%**) of respondents read the advisories that are sent out via email from National Office. Members are time poor and find that they often skim read or ignore the MA's.

Would like to receive
monthly



We currently send out MA's on an "as needed" basis.

Would be happy with an online
format



Just under 40% of respondents prefer printed.

What's coming next

Over the coming months we will be moving to a new schedule for our online communications with some new look emailed communications on a regular schedule. We look forward to trying out this new approach and receiving your feedback. Our new database will also allow you to opt in and out of a variety of communications more easily and to nominate what you wish to receive online.

WEBSITE & MEMBERS ZONE (MZ)

Overall, the website and MZ is underutilised with many members finding them difficult to use. The term 'when necessary' was used frequently by many members when describing their use of both of these platforms.

What's coming next

Greater functionality offered by our new database will allow us to improve the experience for members using the Member Zone. We look forward to sharing these features with you over the coming months.

You will see some initial changes to the website when we move to the new database at the end of July. We will also be making some changes to the Member's Zone and the overall website as we fully implement the functionality of the new system.

EXPRESS CONTENT

Similarly to the MA's, the Express is another well loved communication avenue for our respondents. Some of the comments discussed a large amount of concern regarding the cost of printing the Express. Others felt that the content within the express needed a refresh, whilst some felt that it covers a wide range of useful topics.



Most engaged with:

- Regional News
- Dates for Diaries
- Project Updates



Least engaged with:

- ACWW News
- News from Connectors
- Welcome to new Members



93% of respondents read the Express



81% happy with the frequency of the express

What's coming next

The wide range of feedback on the Express content reflects the different preferences of our membership. We will be introducing the opportunity to receive a hard copy or online copy of the Express from the next edition onwards. We will also be updating the "look and feel" of this publication and experimenting with a different approach to content. We welcome feedback from readers.

GENERAL COMMUNICATIONS

Many respondents commented that they often missed our communications due to being busy and 'time poor'.

They also experience an overload in communications from various organisations, therefore they find it difficult to keep in the loop.

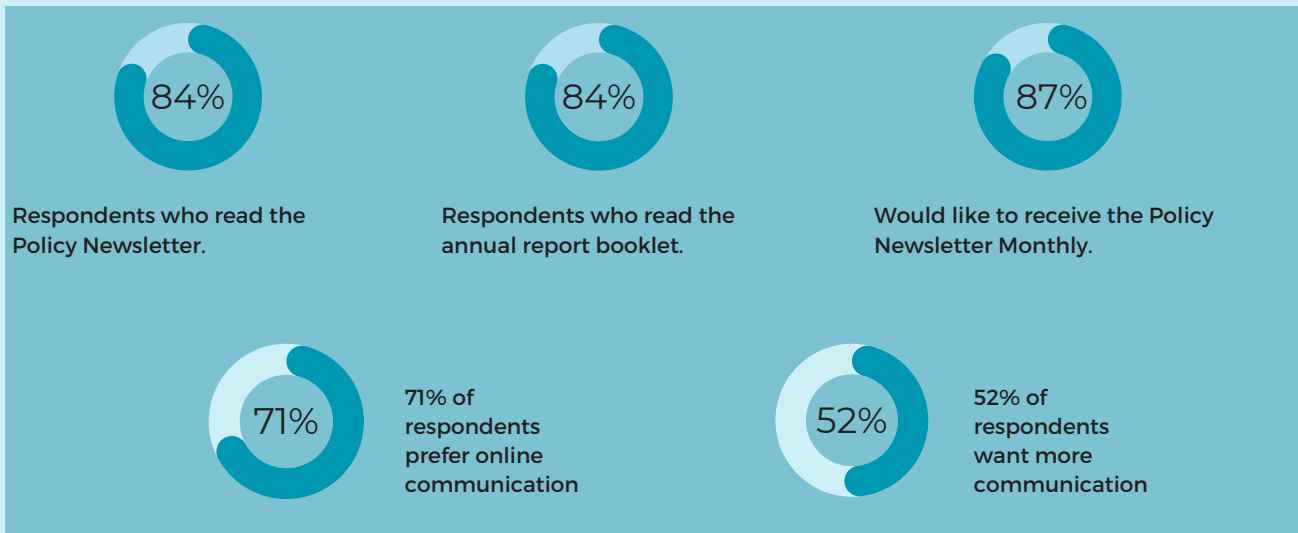

Members enjoy hard copies of the Express and the Annual Reports and some have a preference for this, and find online content overwhelming. However, there is an understanding that we may need to move to online formats, due to printing and postages costs.

Overall, the majority of respondents are happy with the frequency of communications sent out.

Respondents would like to receive more communications from the Board and the Board is working to enhance this through their communications with the Leadership Group and in our Member publications.

MOST EFFECTIVE

- **Emails.**
- Members advisories.
- Facebook.
- Online updates from National and Regional.
- Phone calls.
- Policy Newsletters.
- Friendly Tone.

LEAST EFFECTIVE

- The Website and Members Zone.
- The shop and merchandising area.
- Social media, podcasts, webinars and zoom meetings.
- Spasmodic nature of communications.
- Lengthy reports.

REGIONAL LEADERS & REGIONAL COMMITTEES

Region 1 Lower South Island	Position	Contact Email
Raewyn van Vugt	Regional Leader	whitegold@rivernet.co.nz
Alison Moore	Regional Committee Chair	mooretterritory2017@gmail.com
Jean Hamilton	Minute Secretary	jeansh@yrless.nz
Pat Macaulay	Centennial Committee Chair	pat.macaulay@outlook.com
Lynley White		whyte.5@farmside.co.nz
Eunice Roberts		ebroberts51@gmail.com
Margaret Jones		mjomakau@gmail.com
Barbara Earl		bagjack@xtra.co.nz
Judy Kingan		jaydeekgn@gmail.com

Region 2 Canterbury	Position	Contact Email
Frances Beeston	Regional Leader	francesbeeston@gmail.com
Margaret Chapman	Regional Committee Chair	mgchapman@xtra.co.nz
Sandra Curd	Secretary/Treasurer	curd@xtra.co.nz
Cathy Ritson	Vice Chair	catherine_ritson@yahoo.co.uk
Mary Watson		mmf.wats@gmail.com
Beverly Forrester		forrester@amuri.net
Margaret Chapman [Hook]		royandmargchapman@hotmail.com
Elsa Hydes		esurya@hotmail.com
Michelle Martin		michellemartin1@kpmg.co.nz
Lyn Zuppich		goathills@amuri.net

Region 3 Top of the South	Position	Contact Email
Dot Dixon	Regional Leader	dotsf9@gmail.com
Melva Robb	Regional Committee Chair	melva@soundsreflection.co.nz
Diane Higgins	Secretary and secondary contact	dmhiggins@xtra.co.nz
Margaret Faulkner		NO EMAIL
Jennifer Wiese		NO EMAIL
Carolyn McLellan		balmac@xtra.co.nz
Carol Wells		NO EMAIL
Margaret Milne		margarwpt@kinect.co.nz

Region 4 Lower North Island	Position	Contact Email
Tamzin Coull	Regional Leader	tamzin.coull@xtra.co.nz
Pauline Masters	Regional Committee Chair	paulinemasters@xtra.co.nz
Janice Mills	Secretary	white.rock@farmside.co.nz
Caroline Ross	Treasurer	cross@wise.net.nz
Jean Coleman		ngaios@farmside.co.nz
Joan Black		joanblack@inspire.net.nz
Shona Field		mtwilliam@inspire.net.nz

Region 5 BOP / Coromandel	Position	Contact Email
Mary McTavish	Regional Leader & Regional Committee Chair	jhmemcts@gmail.com
Mary Nowotarski	Deputy Regional Committee Chair	bizykiwi@xtra.co.nz
Jo Gravit	Secretary	pandjgravit@xtra.co.nz
Wendy McGowan	Treasurer	rusty_wendy@xtra.co.nz
Sue Vowell		tepudeer@xtra.co.nz
Chris Paterson		chrisjam@xtra.co.nz
Margaret Scrimgeour		jmscrimgeour@gmail.com
Maureen Champion		sparkysark@kinect.co.nz
Bev Sanford		jsanford@xtra.co.nz

Region 6 Greater Waikato	Position	Contact Email
Bronwyn Main	Regional Leader	bronwynmain45@gmail.com
Liz Morgan	Regional Committee Chair & Treasurer	lizziemorgan36@gmail.com
Denise Irvine		denise.irvine@e3health.co.nz
Jenni Torrens		torrensfarms@xtra.co.nz
Fiona Gower		fionagower@hotmail.com

Region 6 Taranaki	Position	Contact Email
Shirley Read	Regional Leader & Committee Chair	sdread@xtra.co.nz
Helen Bayliss	Secretary	harrybayliss@xtra.co.nz
Joyce Lawrence	Treasurer	niaruo@inspire.net.nz
Margaret Vickers		r.m.vickers@xtra.co.nz
Jennie Purdon		chrisjen1@orcon.net.nz
Jo Morgan		morgl@xtra.co.nz
Sue Brophy		t.sbrophy@icloud.com

Region 7 Top of the North	Position	Contact Email
Heather Sorenson	Regional Leader	heathersorensen55@gmail.com
Noelene Price-Quedley	Secretary & Newsletter	noeleneq@hotmail.com
Marie Alpe	Treasurer	mariealpe60@gmail.com
Christine Pikett		c/o mary_p@xtra.co.nz
Margaret Smiley		margaretsmiley@gmail.com



REGIONAL LEADERS

Region	Name	Contact Phone	Mobile	Contact Email
1	Raewyn van Vugt	03 415 9207	027 448 8957	whitegold@rivernet.co.nz
2	Frances Beeston		027 648 8379	francesbeeston@gmail.com
3	Dot Dixon		022 639 7175	dotsf9@gmail.com
4	Tamzin Coull		027 309 3616	tamzin.coull@xtra.co.nz
5	Mary McTavish	07 543 2521	021 141 6432	jhmemcts@gmail.com
6	Shirley Read (Taranaki)	06 752 3698	027 665 9047	sdread@xtra.co.nz
6	Bronwyn Main (Greater Waikato)	07 825 4727		bronwynmain45@gmail.com
7	Heather Sorensen	09 401 6176	0274 724 485	heathersorensen55@gmail.com

Rewarding **Rural** Businesswomen



Women in the rural sector are a force to be reckoned with. Through their passion, commitment and hard work they play a significant role in ensuring communities remain resilient and prosperous.

The NZI Rural Women NZ Business Awards recognise Kiwi businesswomen at the heart of rural New Zealand.

**You work hard. Let's celebrate that.
Enter now.**

nzi.co.nz/awards



Peace of mind
for NZ business

NZ7423 4/23



Ngā Wāhine Taiwhenua o Aotearoa

Rural Women New Zealand National Office 04 473 5524
Level 10, 175 Victoria Street, Wellington 6011
PO Box 12-021, Thorndon, Wellington 6144
www.ruralwomennz.nz 0800 256 467

© 2023. Rural Women New Zealand Inc (and subsequent years) All rights reserved. This publication is entitled to the full protection given by the Copyright Act 1994 to the holders of the copyright. Reproduction of all or any substantial parts of the publication is in breach of the copyright of the publisher Rural Women New Zealand Inc. This copyright extends to all forms of photocopying and any storing of material in any kind of information retrieval system. All applications for reproduction in any form should be made to the publishers – Rural Women New Zealand Inc.